



Voltage:	~220-240V, 50-60 HZ
Protection class:	II IP20
Standards:	See Technical Data Below

**Description**

LED Emergency Luminaire

The EXIDA ESSENCE CO 3W DALI SELF TEST is a recessed LED emergency luminaire, with an Corridor Escape Route distribution. The luminaire features articulated control gear for flexibility use in restricted ceiling voids. The EXIDA ES lamphead contains an integrated bi-colour LED indicator and hidden test switch (for use in self test mode only), 180mm wiring loom and recessed mounting brackets to make installation quick and simple, finish is available in white or black, please state on order. The EXIDA ES DA continues our range of LED Emergency luminaires designed to be effective and unobtrusive.

- (W) WHITE LED Head Finish- 97-EXES CO DA W
- (B) BLACK LED Head Finish- 97-EXES CO DA B

**Product Image**



**Technical Data**

Supply Voltage/Frequency	230VAC / 50-60Hz
Ceiling cutout size/min void height	42mm Dia / 110mm void
Supply Current (Max) / Battery Type	30mA max / 2.4V 4Ah NiMH
Total Circuit Power Nom (Max)	2.0W (3.5W)
Power Factor	0.44
Ambient Temperature (ta)	10°C To +35°C
Ingress Protection	IP20
Weight	590g
Conductor Size	0.2-1.5mm² max
Luminous Flux	155lm
CCT	>5500K
Emergency Duration	3 Hours
Recharge Period	24 Hrs
Lens Distribution	Open Area
Self Test	Yes, full self test function with no DALI connection
DALI Test	Yes, for use in conjunction with a DALI control system
Relevant Standards	EN 60598-2-22 EN 61347-1 EN 61347-2-7 EN55015 EN 61000-3-2 EN 61547

**Drawing / Dimensions**

Dimens. [mm]		
L	W	H
50 Dia	-	53

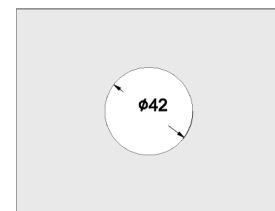
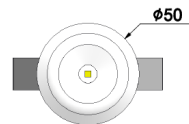
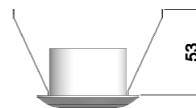

CUTOUT SIZE

**Polar Distribution:**

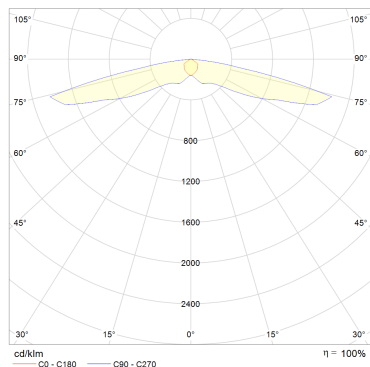

**Spacing information**

Escape Route (based on min. 1.0 lux)

Mounting Height (m)	Distance Luminaire to Luminaire (m)	Distance Luminaire to wall (m)
2.0	16.72	6.97
2.5	19.05	7.26
3.0	20.17	7.07
3.5	20.73	6.31
4.0	20.45	5.94